



NORTH - WEST

venia
THE SLEEK PERFORMER



SWITCH TO SIMPLICITY

Sleek switch

Satin finish

Sturdy design



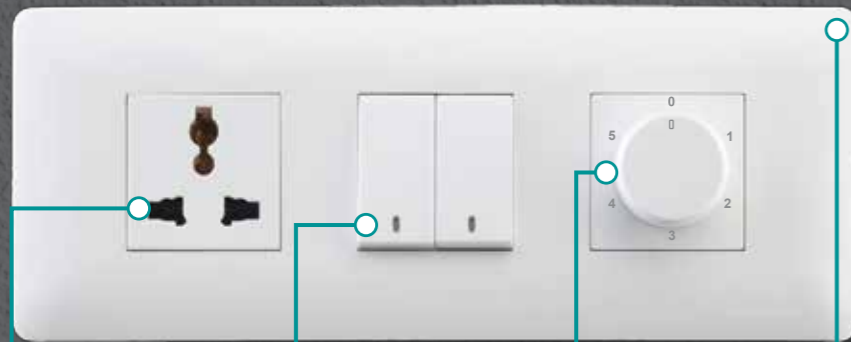

Vertical shutter movement for penless operation

Neon Indicator switches

360 degree rotating hum free fan regulator

Aesthetic curved plate design

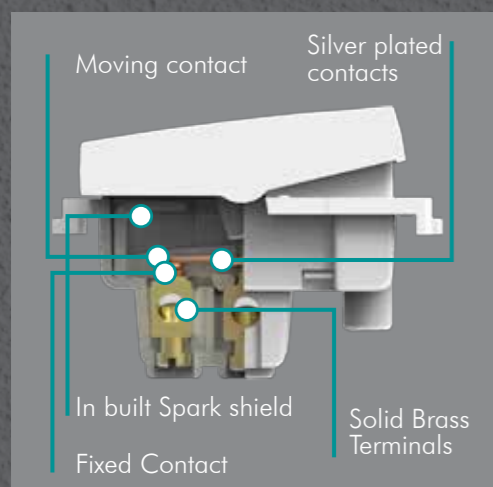
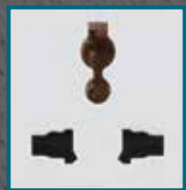

Positive Locks for sturdy locking

Criss-cross designed grid plates provides better strength

Shrouded terminals for better safety



| Cat No | Module | Description | Packs (Nos.) |
|--------|--------|-------------|--------------|
|--------|--------|-------------|--------------|

SWITCHES

| | | | |
|-------|----|--|--------|
| B0110 | 1M | Switch 6A One Way | 20/600 |
| B0111 | 1M | Switch 6A One Way with Indicator | 20/600 |
| B0210 | 1M | Switch 6A Two Way | 20/600 |
| B0130 | 1M | Switch 16A One Way | 20/600 |
| B0131 | 1M | Switch 16A One Way with Indicator | 20/600 |
| B0551 | 2M | Switch 32A One Way with Indicator - DP | 10/600 |
| B0310 | 1M | Bell Push 6A | 20/600 |
| B0311 | 1M | Bell Push 6A with Indicator | 20/600 |
| B0341 | 2M | Bell Push 6A with Indicator - Palm | 10/600 |

SOCKETS

| | | | |
|-------|----|---------------------------------|--------|
| B1212 | 2M | Socket 6A 3 - Pin With Euro Pin | 10/300 |
| B1410 | 2M | Socket 6A 2/3 Pin | 10/300 |
| B1332 | 2M | Socket 6/16A 3 Pin - Power | 10/300 |
| B1352 | 2M | Socket 6/25A 6 Pin - Power | 10/300 |
| B1532 | 2M | Socket 6/13A - International | 10/300 |

FAN REGULATORS

| | | | |
|-------|----|---|--------|
| B1700 | 1M | Fan Regulator 4+1 Position Step Type 360° | 10/300 |
| B1900 | 2M | Fan Regulator 5+1 Position Step Type 360° | 6/180 |

COMMUNICATION MODULES

| | | | |
|-------|----|---|--------|
| B4900 | 1M | Telephone Socket with Single Shutter RJ11 | 20/600 |
| B4797 | 1M | Co-Axial Tv Socket 1 Point | 20/600 |
| B5100 | 1M | Computer Socket with Shutter -RJ45 Cat 5 | 20/600 |
| B5200 | 1M | Computer Socket with Shutter -RJ45 Cat 6 | 20/600 |

| Cat No | Module | Description | Packs (Nos.) |
|--------|--------|-------------|--------------|
|--------|--------|-------------|--------------|

COVER PLATES

| | | | |
|---------|-----|-----------------------------------|--------|
| BBP911 | 1M | 1M Plate With Frame | 15/360 |
| BP922 | 2M | 2M Plate With Frame | 15/360 |
| BP933 | 3M | 3M Plate With Frame (Rib) | 10/240 |
| BP944 | 4M | 4M Plate with frame | 8/192 |
| BP956 | 6M | 6M Plate With Frame | 5/120 |
| BP968H | 8M | 8MH Plate With Frame (Horizontal) | 5/120 |
| BP968S | 8M | 8MS Plate With Frame (Square) | 5/95 |
| BP9712S | 12M | 12M Plate With Frame | 5/95 |
| BP9718S | 18M | 18M Plate With Frame | 5/40 |
| B3900 | 1M | Blanking Plate | 30/900 |

SAFETY DEVICES

| | | | |
|----------|----|--------------------------------|-------|
| BTT6ASP | 1M | 6A Single Pole Tiny Trip | 10/80 |
| BTT10ASP | 1M | 10A Single Pole Tiny Trip | 10/80 |
| BTT16ASP | 1M | 16A Single Pole Tiny Trip | 10/80 |
| BTT20ASP | 1M | 20A Single Pole Tiny Trip | 10/80 |
| BTT25ASP | 1M | 25A Single Pole Tiny Trip | 10/80 |
| BTT32ASP | 1M | 32A Single Pole Tiny Trip | 10/80 |
| BTT6ADP | 2M | 6A Double Pole Tiny Trip | 4/32 |
| BTT10ADP | 2M | 10A Double Pole Tiny Trip | 4/32 |
| BTT16ADP | 2M | 16A Double Pole Tiny Trip | 4/32 |
| BTT20ADP | 2M | 20A Double Pole Tiny Trip | 4/32 |
| BTT25ADP | 2M | 25A Double Pole Tiny Trip | 4/32 |
| BTT32ADP | 2M | 32A Double Pole Tiny Trip | 4/32 |
| BMS20A | 2M | 20A Motor Starter Single Phase | 4/32 |
| BMS25A | 2M | 25A Motor Starter Single Phase | 4/32 |

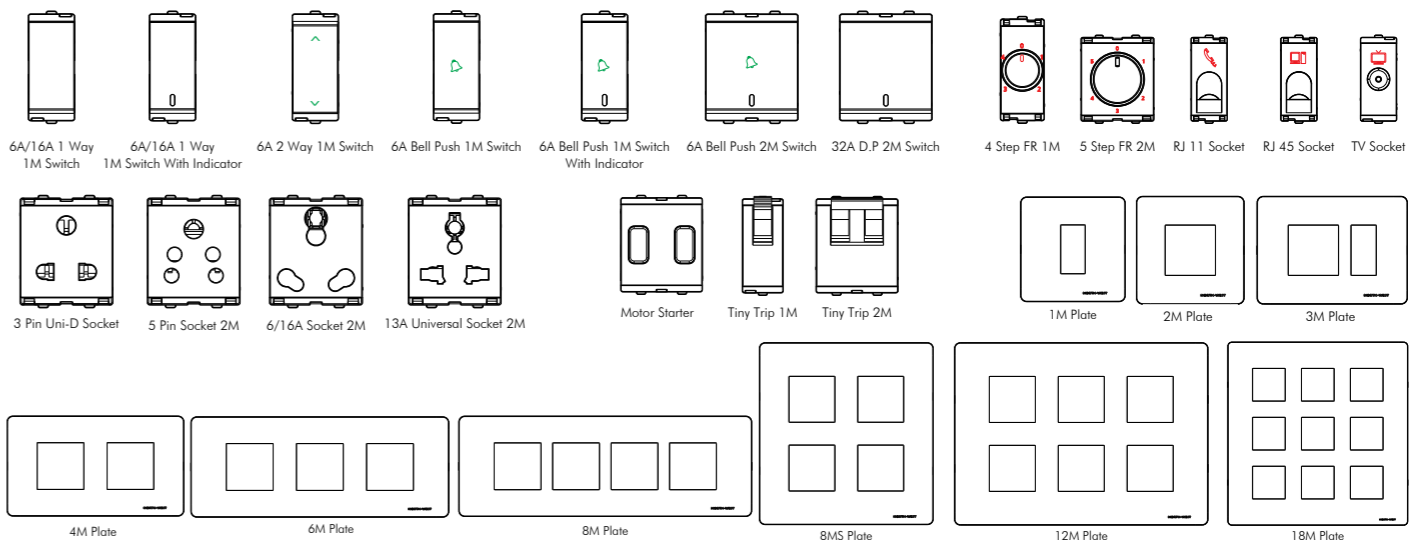

Contact us

| | | | |
|------------|-----------------------|-----------|--------------------------|
| Ahmedabad | 02718-321819/262710 | Indore | 0731-4023486 |
| Ambala | 0171-2522035 | Jaipur | 0141-2280014 |
| Aurangabad | 0240-6003077/6002077 | Kolkata | 033-22829268/44045887 |
| Bangalore | 080-41215810/40541950 | Lucknow | 0522-2434352 |
| Chandigarh | 0172-5018734/2660714 | Mumbai | 022-67213757/67213755-63 |
| Chennai | 044-24769653 | Nagpur | 0712-2569878 |
| Cochin | 0484-6555545/2421168 | New Delhi | 011-41708122-29 |
| Dehradun | 0135-2620912 | Pune | 020-25535081/25535401 |
| Hyderabad | 040-27176082/3939 | Raipur | 0771-3265725 |

10 Year Warranty

The Company undertakes to replace or repair products at its discretion, should they become defective solely as a result of faulty material and or workmanship within 10 years in the case of electro-mechanical wiring products, such as unpainted/noncoated switches, sockets, plates, switches without indicators. 1.5 years in the case of mains related electronic wiring device products such as fan regulators, dimmers, switches with LED indicators Hospitality & communication modules including indicator Modules and one year in case of surface coated products like Distribution Boards, coated plates, metal plates & metal boxes. Also one year in case of protection devices like MCB, Tiny-Trip, Motor Starters and RCCB. The guarantee will be invalidated if the product has not been installed or maintained in accordance with the Company's instructions, or if any attempt has been made to rectify, dismantle or alter the product or if the products are not accompanied with purchase bill/s or warranty card. The guarantee states the Company's entire liability. It does not extend to cover consequential loss or damage or installation costs arising from the defective product.



NORTH-WEST

WIPRO ENTERPRISES (P) LIMITED,

Registered Office: 134, Doddakannelli, Sarjapur Road, Bangalore - 560 035, India

Write to: Wipro Consumer Care, Doddakannelli, Sarjapur Road, Bangalore - 560

035 Call Toll free no.: 1-800-425-1969

Email us at: feedback.wcc@wipro.com

Visit us at: www.north-west.wipro.com [facebook.com/WiproNorthWestSwitches](https://www.facebook.com/WiproNorthWestSwitches)